









**LEGEND**

-  Public Corridors
-  Entrance
-  Waiting Areas
-  Information Kiosk
-  Public Elevators
-  Restrooms
-  Public & House Phones
-  Stairways
-  Internet Station

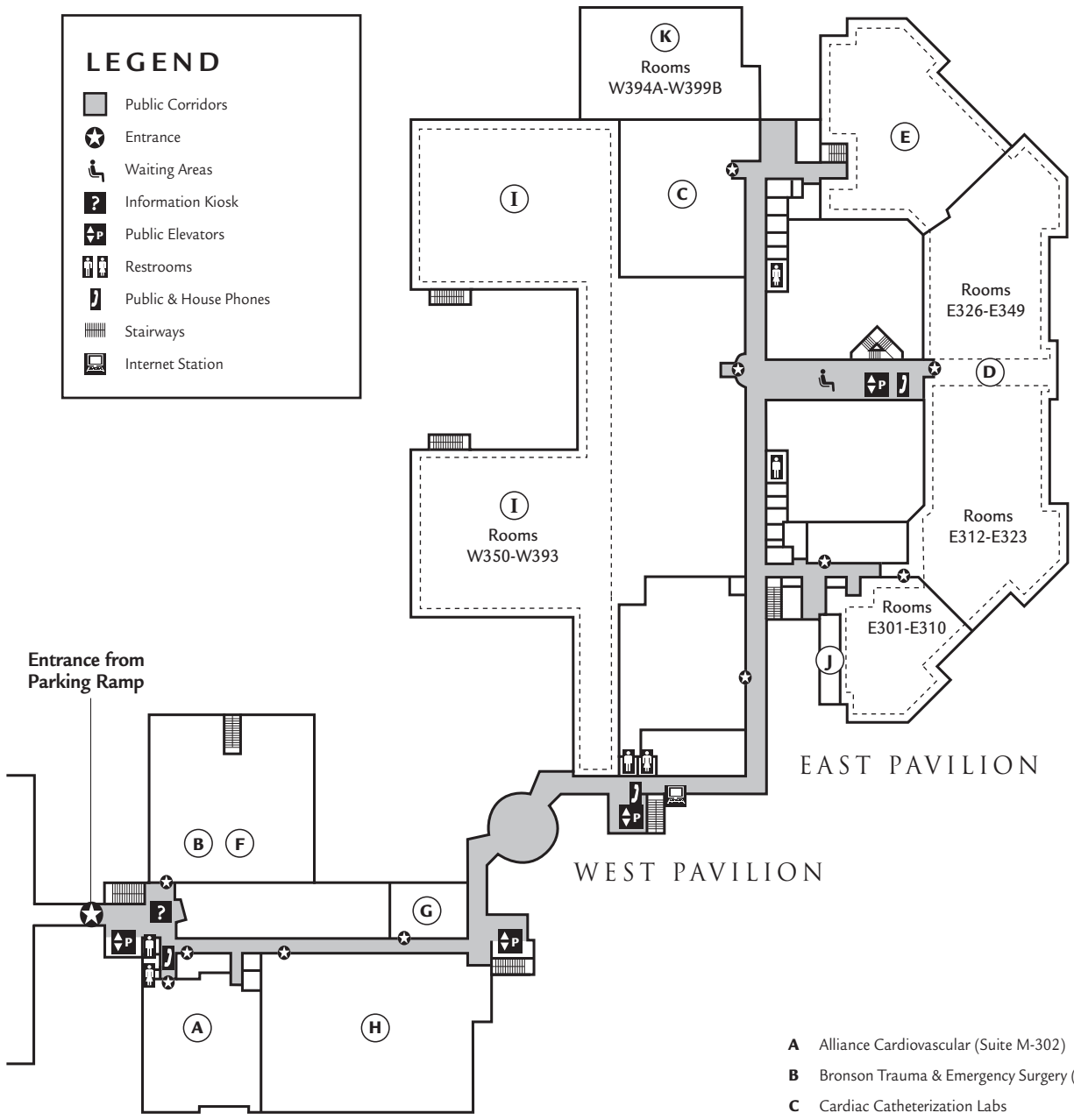

MEDICAL OFFICE PAVILION

WEST PAVILION

EAST PAVILION



**THIRD FLOOR**

South Campus

**Bronson Methodist Hospital**

601 John Street, Kalamazoo, MI 49007

- A** Alliance Cardiovascular (Suite M-302)
- B** Bronson Trauma & Emergency Surgery (Suite M-351)
- C** Cardiac Catheterization Labs
- D** **The Children's Hospital**  
Patient Rooms E301-E349
- E** **The Children's Hospital**  
Pediatric Intensive Care Unit
- F** **The Children's Hospital**  
Pediatric Subspecialties (Suite M-351):  
Cardiology, Echocardiology, Gastroenterology,  
Apnea Center, Pediatric Surgery
- G** Heart Center for Excellence (Suite M-325)
- H** OB-GYN P.C. (Suite M-318)
- I** Ortho Surgical Unit (OSU)  
Patient Rooms W350-W393
- J** Pediatric Sedation Unit (E301-302)
- K** Prep and Recovery Unit (W394A-399B)